



42 KINGSWOOD DRIVE NOTTINGHAMSHIRE, NG17 8PY

£895 PCM

Nestled in the charming area of Kingswood Drive, Kirkby in Ashfield, Nottinghamshire, this delightful two-bedroom terraced house presents an excellent opportunity for those seeking a comfortable family home. The property boasts a well-proportioned reception room, perfect for relaxation or entertaining guests.

The newly fitted bathroom adds a touch of modernity, ensuring convenience for daily routines. Freshly painted walls and new carpets throughout the house create a bright and inviting atmosphere, making it easy for you to move in and make it your own.

This family house is designed to cater to your needs, offering a practical layout that maximises space and functionality. The long driveway provides ample parking for up to two vehicles, a valuable feature in this area. It also has a secure rear garden with shed.



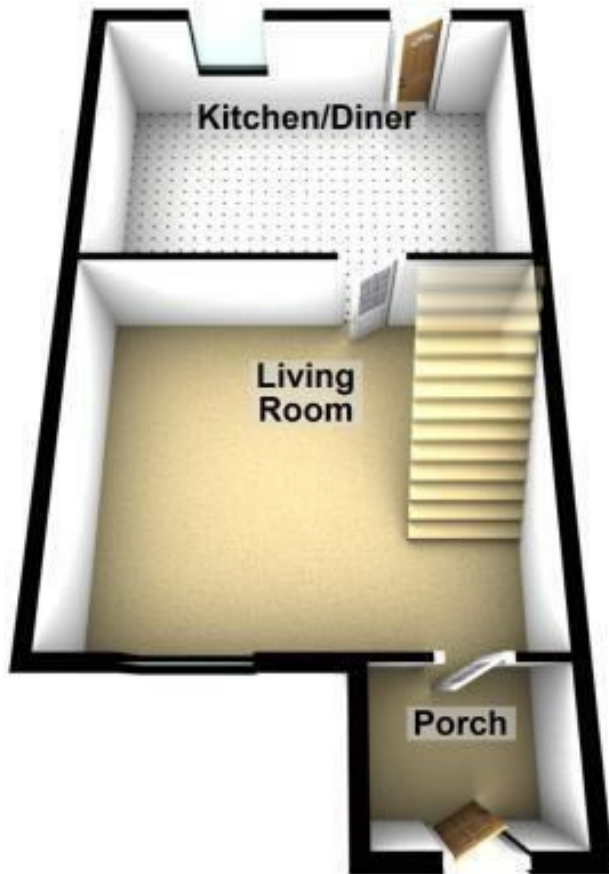

White House
Lettings

Ground Floor

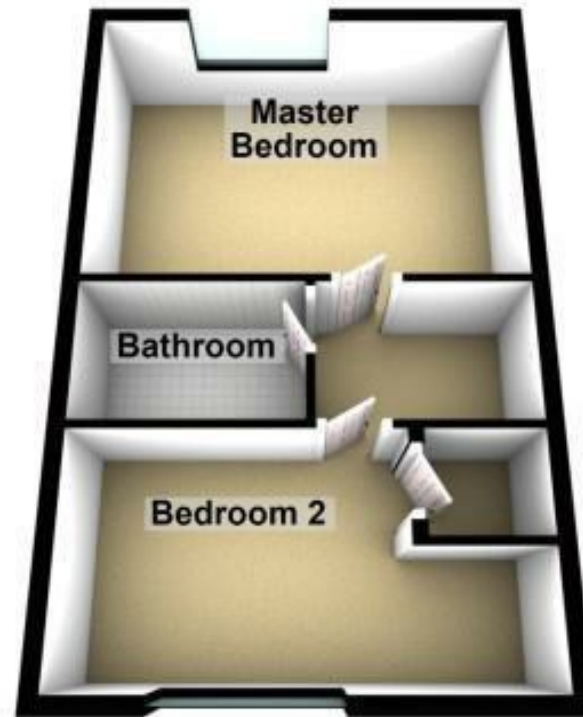

First Floor



Energy Efficiency Rating		
	Current	Potential
Very energy efficient - lower running costs		
(92 plus) A		88
(81-91) B		
(69-80) C		
(55-68) D	73	
(39-54) E		
(21-38) F		
(1-20) G		
Not energy efficient - higher running costs		
England & Wales	EU Directive 2002/91/EC 	



White House
Lettings

White House Lettings Lettings
Lower Portland
Kirkby-In-Ashfield
Nottingham
Nottinghamshire
NG17 9LD

01623 403032
enquiries@whitehouselettings.co.uk
<https://www.whitehouselettings.co.uk>

Agents Note: Whilst every care has been taken to prepare these particulars, they are for guidance purposes only. All measurements are approximate and are for general guidance purposes only and whilst every care has been taken to ensure their accuracy, they should not be relied upon and potential buyers/tenants are advised to recheck the measurements